

INSTALLATION INSTRUCTIONS FOR LATCHSETS

Installing Latch - Skip to #4 Instruction if door is pre-bored.

- Using template, mark all points for drilling. Use correct backset for latch. Drill $2\frac{1}{8}$ " bore first. **For 2" diameter roses or narrow plates drill $\frac{3}{4}$ " diameter hole instead of $2\frac{1}{8}$ " bore.**
- Using 1" bit, drill from door edge across the bore to accommodate latch length.
- With face cover in place, position latch and mark perimeter of latch faceplate on door edge. Mortise to accommodate latch face and face cover, approximately $\frac{5}{32}$ " deep (refer to Figure #1).
- PASSAGE :** When installing a passage latch, hold latch with writing facing upwards.
PRIVACY : When installing privacy latch, the side of the privacy that is inside of the room must be towards locking side of room. (refer to Figure #2 on reverse side).
To change latchbolt position, pull latchbolt out slightly and rotate 180 degrees.
- Position latch [G] in door to suit bevel (refer to Figure #1). Rotate latch bolt if necessary, using slight pressure. Screw faceplate and latch to door.

BEFORE INSTALLING ROSE:

- Insert spindle [F] through latch hub. **FOR PRIVACY FUNCTION: Insert split spindle until spindle stop hits latch hub.**

Installing Passage and Privacy Rose Set (refer to Figure #4)

- Place the adaptor [E] and adaptor [J] into the door prep, on either side of the door. Fasten the adaptors together using the (2) screws [K] provided by passing them through the adaptor [J] and into the adaptor [E]. (do not fully tighten). **Install the nylon threaded washers [C] onto the adaptors before applying roses [D] and [L].** Make sure the spindle [F] is centered in the hole of the adaptors [E] and [J].
- Place levers [A] onto each end of spindle [F] and test operation of latch. If operation is smooth, fully tighten screws [K] and remove washers [C] and levers [A].
- Place a finished rose [D] and [L] onto each adaptor. For privacy function, ensure that the privacy hole is towards the door edge. Thread washers [C] onto inside and outside adaptors securing the finished roses [D] and [L]. Use the washer installation tool [N] to fully tighten each threaded washer [C].
- Slide both levers [A] onto the spindle [F] until securely seated into the threaded washers [C]. (For privacy function, ensure the spindle [F] is centered in the latch [G] so that each lever [A] works independently). Insert the set screws [B] provided into the levers [A] and secure the levers [A] to the spindle [F]. If installing privacy function, thread the privacy pin [M] through the rose [L] into the latch.

Your Omnia Dealer/Distributor can help you with any further questions or information on other Omnia Products.

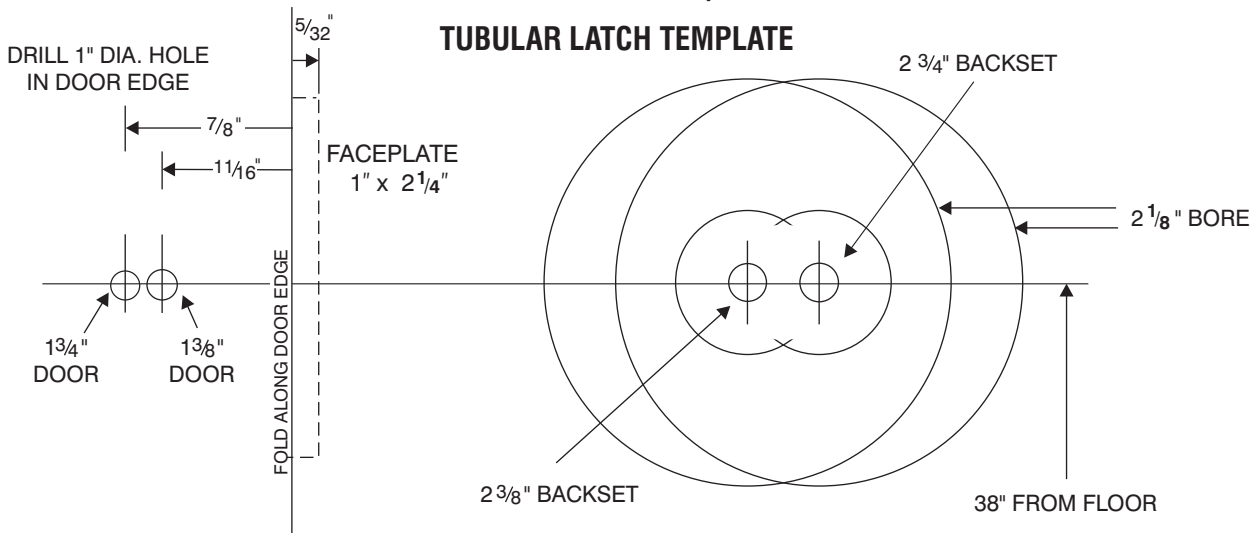
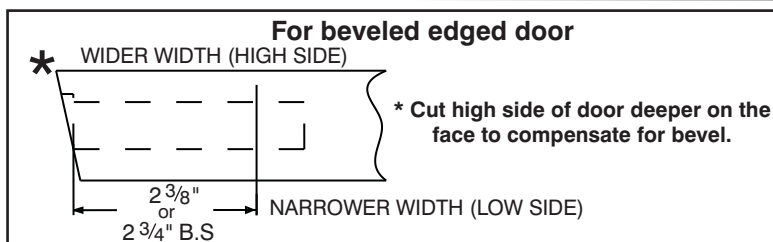

Figure #1



CAUTION: DOOR AND FRAME MANUFACTURERS

When door gasketing or silencers are used, proper allowances must be made for strike location to maintain a common centerline with lock and door so that the bolt will freely enter strike.

**INSTALLATION OF PRIVACY LATCH
(PRIVACY LATCH ONLY)**

Figure #2

Hold latch with writing on label facing inside. The side of the latch that is inside of the room must be towards you.

***NOTE Thread privacy pin into latch after trim is applied.**

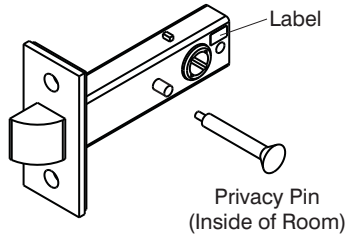

Figure #3

**FACEPLATE AND STRIKES
DRAWINGS NOT TO SCALE**

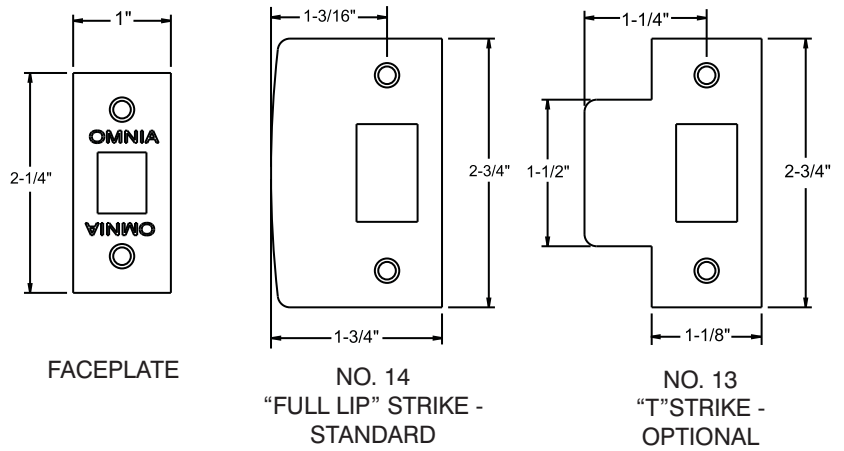
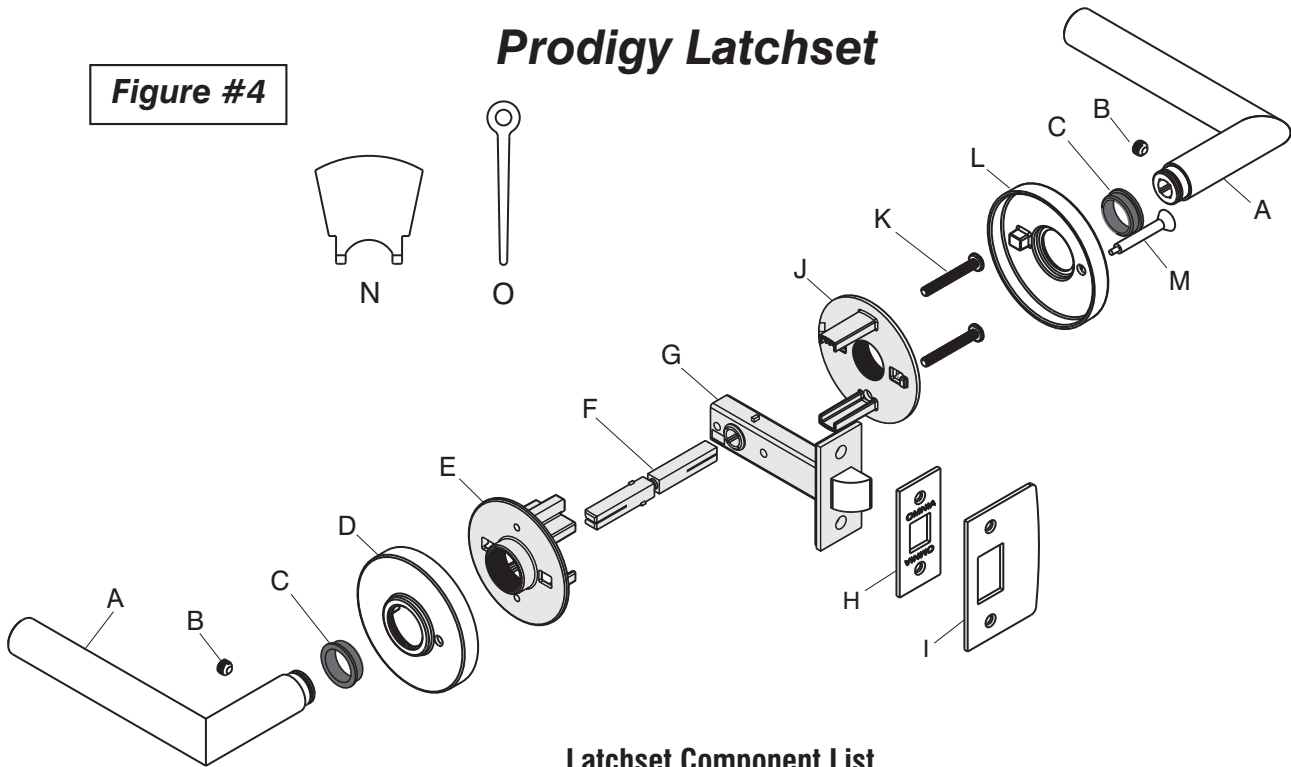

Figure #4

Prodigy Latchset



Latchset Component List

- | | |
|---|---|
| <ul style="list-style-type: none"> A) Door knob/lever (2) B) Set screws (2) C) Nylon threaded washers (2) D) Finished Rose E) Adaptor E F) Spindle (Teardrop groove positioned towards set screw) G) Tubular latch | <ul style="list-style-type: none"> H) Tubular latch faceplate I) Tubular latch strike plate J) Adaptor J K) Thru-bolts (2) L) Finished Rose M) Privacy locking pin N) Washer Installation Tool O) Emergency Release Key |
|---|---|